

Height	1470.0 mm
Width	2300.0 mm
Depth	500.0 mm
Height (Upper Strip)	60.0 mm
Elevation (Plinth)	0.0 mm

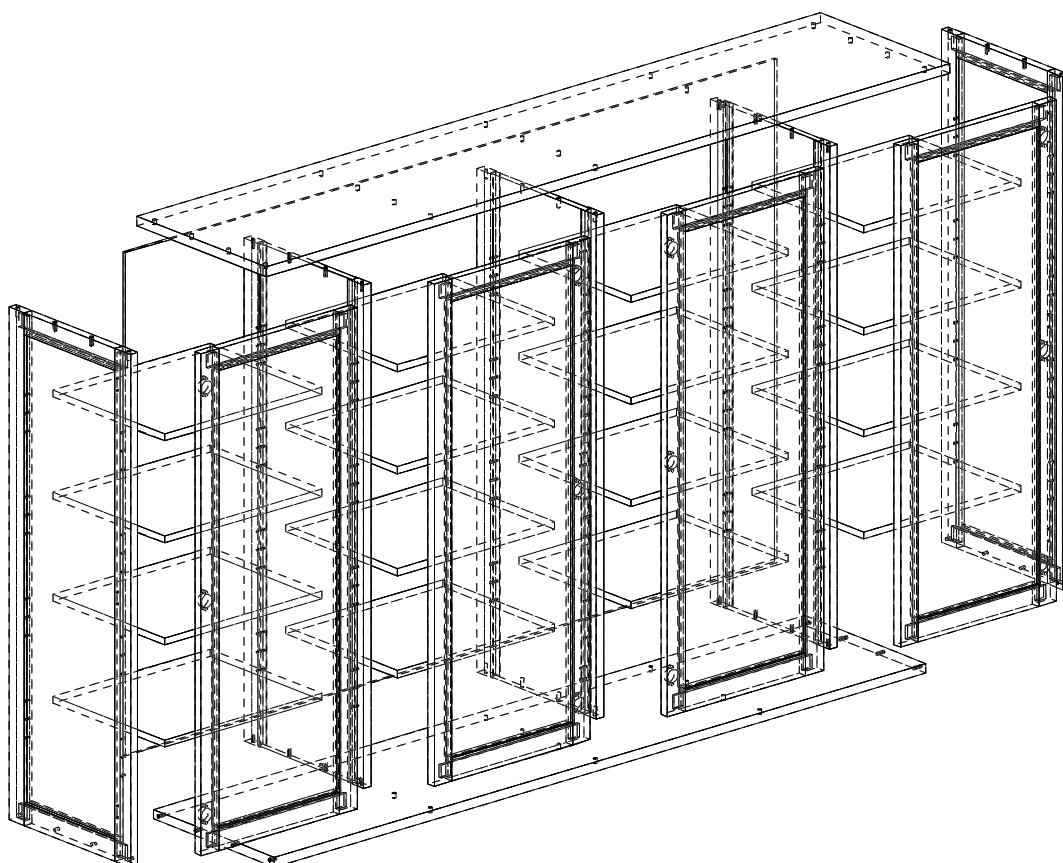
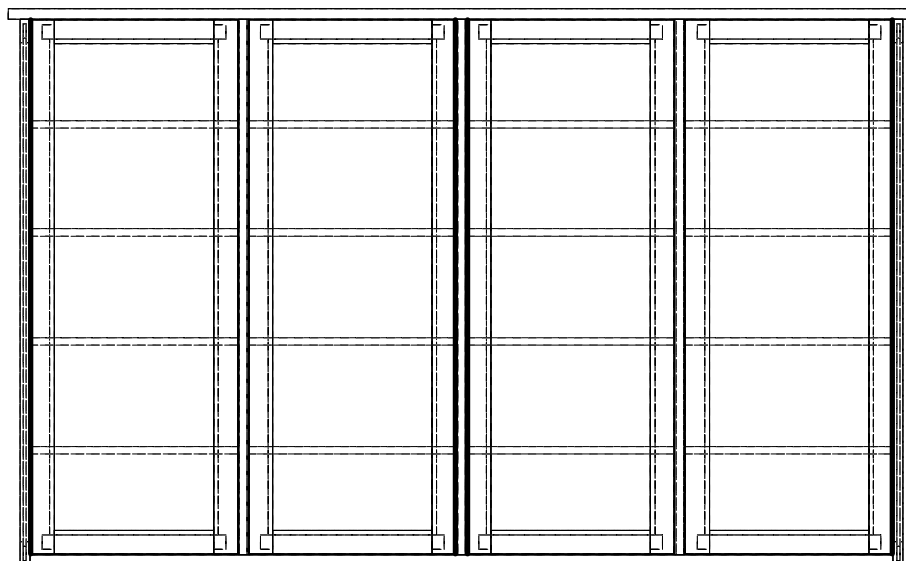

Cutting List (Panel : Net Dimensions) 08mm Glass, 8.0

Reference	Height	Width	Quantity	Grain	Left Edge	Right Edge	Bottom Edge	Top Edge
Simple Door [1], Simple Door [2]...	1258.0	428.8	4	No				

Cutting List (Panel : Net Dimensions) 08mm melon, 8.0

Reference	Height	Width	Quantity	Grain	Left Edge	Right Edge	Bottom Edge	Top Edge
Left Side	1288.0	374.0	1	Yes				
Right Side	1288.0	374.0	1	Yes				
Back	1358.0	2190.0	1	Yes				

Cutting List (Panel : Net Dimensions) 19mm Burnished Pine veneer, 19.0

Reference	Height	Width	Quantity	Grain	Left Edge	Right Edge	Bottom Edge	Top Edge
Mobile Shelf [1], Mobile Shelv...	528.8	433.0	16	No				
Vertical Division [1], Vertical Div...	1358.0	366.0	2	No				
Vertical Division [2]	1358.0	366.0	1	No				

Cutting List (Panel : Net Dimensions) 26 Veneered MDF steamed Beech, 26.0

Reference	Height	Width	Quantity	Grain	Left Edge	Right Edge	Bottom Edge	Top Edge
Top	2300.0	500.0	1	Yes				
Bottom	2190.0	470.0	1	Yes				

Cutting List (Bar) beech 80x25, 60.0 × 25.0

Reference	Length	Quantity
Left Side_1	410.0	1
Left Side_2	1384.0	1
Left Side_3	410.0	1
Left Side_4	1384.0	1
Right Side_1	410.0	1
Right Side_2	1384.0	1
Right Side_3	410.0	1
Right Side_4	1384.0	1
Vertical Division [1]_1, Vertical Division [2]_1, Vertical Division [3]_1	1358.0	3
Vertical Division [1]_2, Vertical Division [2]_2, Vertical Division [3]_2	1358.0	3
Simple Door [1]_1	464.8	1
Simple Door [1]_2	1354.0	1
Simple Door [1]_3	464.8	1
Simple Door [1]_4, Simple Door [2]_2, Simple Door [3]_4, Simple Door [4]_2	1354.0	4
Simple Door [2]_1	464.8	1
Simple Door [2]_3	464.8	1
Simple Door [2]_4	1354.0	1
Simple Door [3]_1	464.8	1
Simple Door [3]_2	1354.0	1
Simple Door [3]_3	464.8	1
Simple Door [4]_1	464.8	1
Simple Door [4]_3	464.8	1
Simple Door [4]_4	1354.0	1

Recapitulatory

Panel	Surface	Price (€/m²)	Price
08mm Glass, 8.0	2.16 m²	20.00	43,15 €
08mm melon, 8.0	3.94 m²	202.00	795,36 €
19mm Burnished Pine veneer, 19.0	5.15 m²	20.00	103,09 €
26 Veneered MDF steamed Beech, 26.0	2.18 m²	21.46	46,77 €
Total			988,37 €
Bar	Length	Price (€/m)	Price
beech 80x25, 60.0 × 25.0	29.9 m		0,00 €
Total			0,00 €
Fittings	Quantity	Unit Price	Price
Dowel 8mm	40	0.40	16,00 €
Hinge Blum built-in	12	3.70	44,40 €
Shelf Pegs mobile x3	64	0.20	12,80 €
Total			73,20 €
Overall Total			1 061,57 €

Top 26 Veneered MDF steamed Beech Height: 2300.0 Width: 500.0 Thickness: 26.0 Quantity: 1
00001175

Drilling A (20) Diameter: 8.0 Depth: 13.0

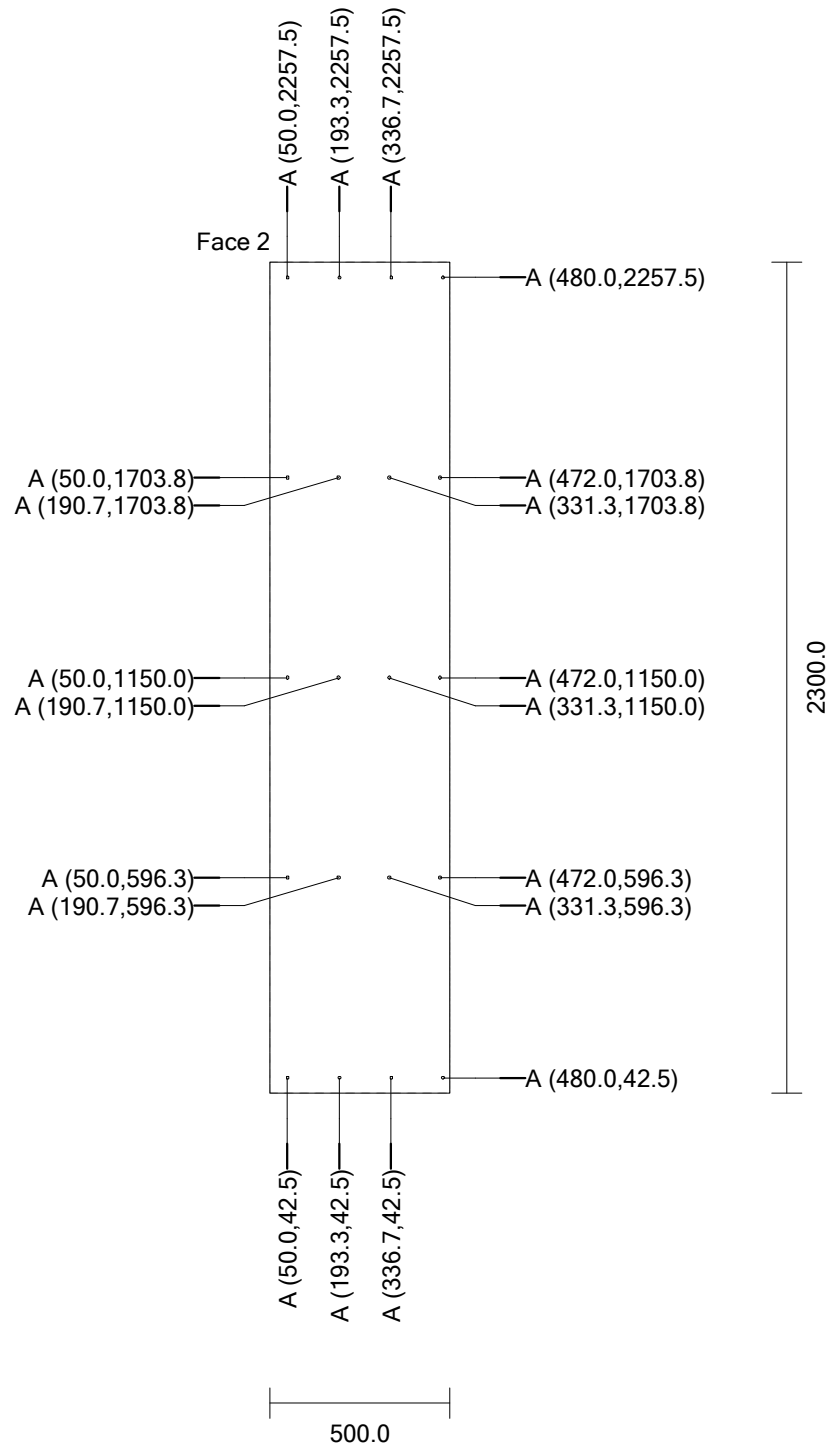

Bottom 26 Veneered MDF steamed Beech Height: 2190.0 Width: 470.0 Thickness: 26.0 Quantity: 1
00001176

Drilling A (12) Diameter: 8.0 Depth: 13.0
B (8) Diameter: 8.0 Depth: 24.0

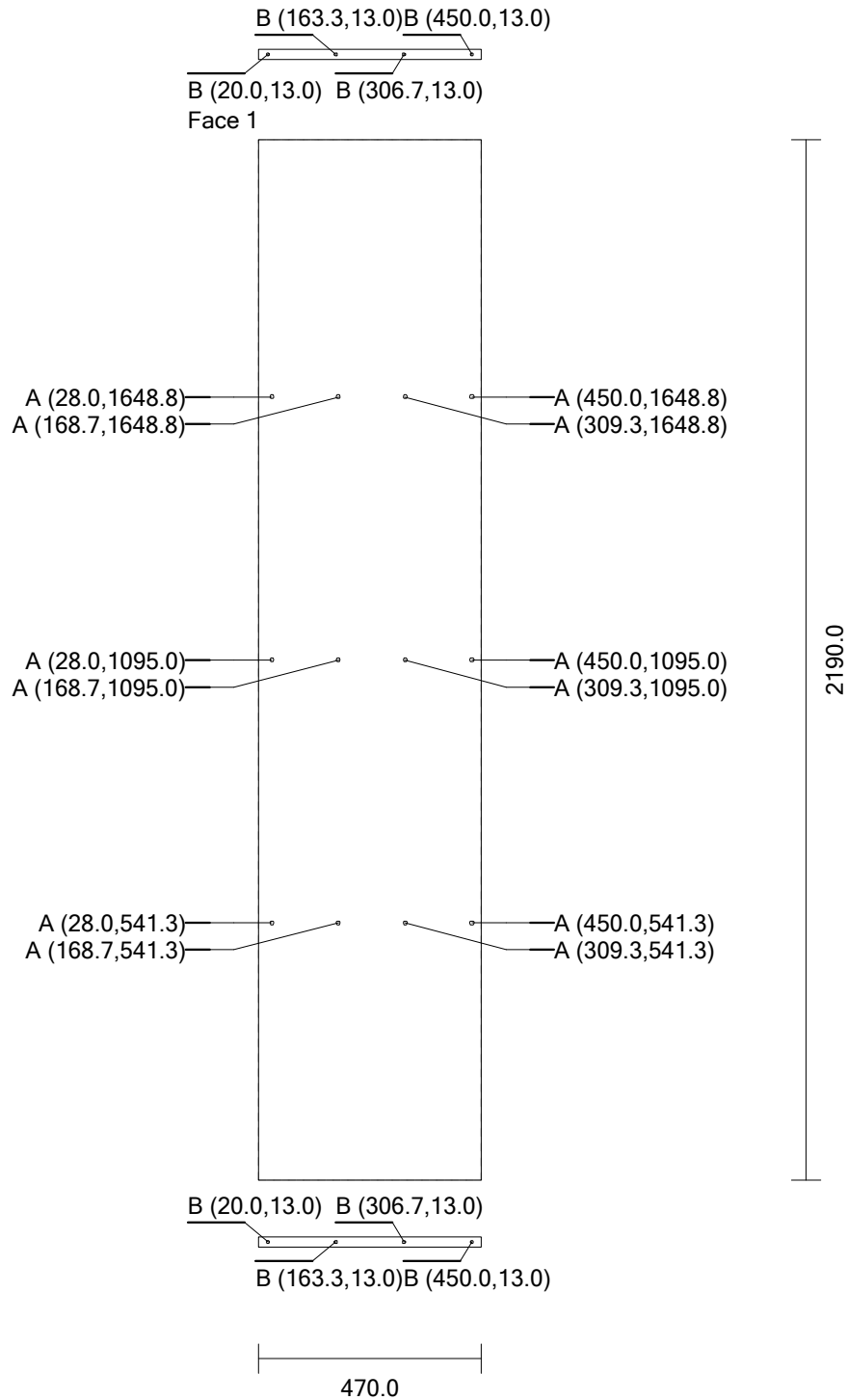

Left Side
00001177

08mm melon

Height: 1288.0

Width: 374.0

Thickness: 8.0

Quantity: 1

Drilling

C (6)

Diameter: 5.0

Depth: 3.5

D (24)

Diameter: 5.0

Depth: 4.5

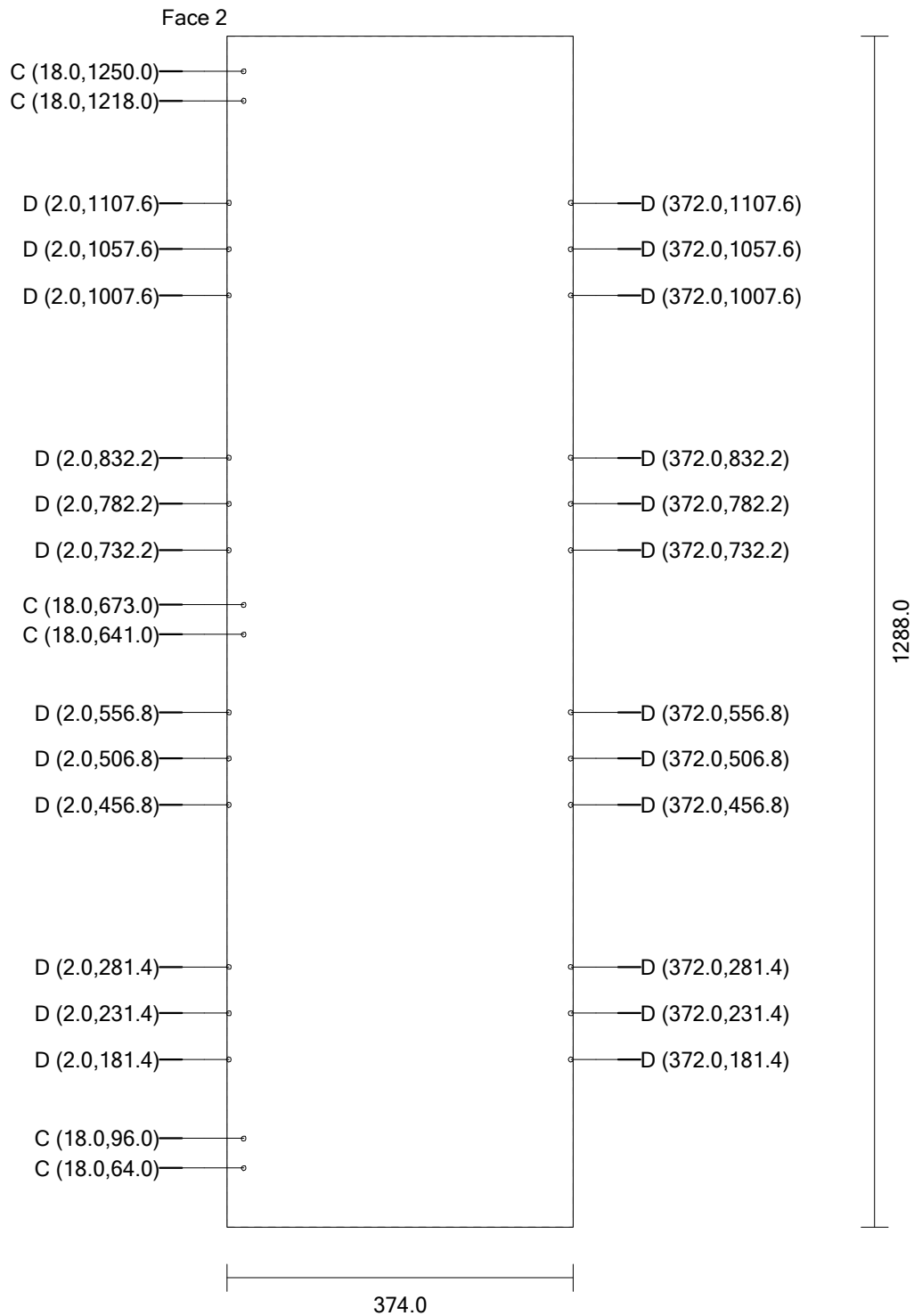

Right Side
00001178

08mm melon

Height: 1288.0

Width: 374.0

Thickness: 8.0

Quantity: 1

Drilling

C (6)

Diameter: 5.0

Depth: 3.5

D (24)

Diameter: 5.0

Depth: 4.5

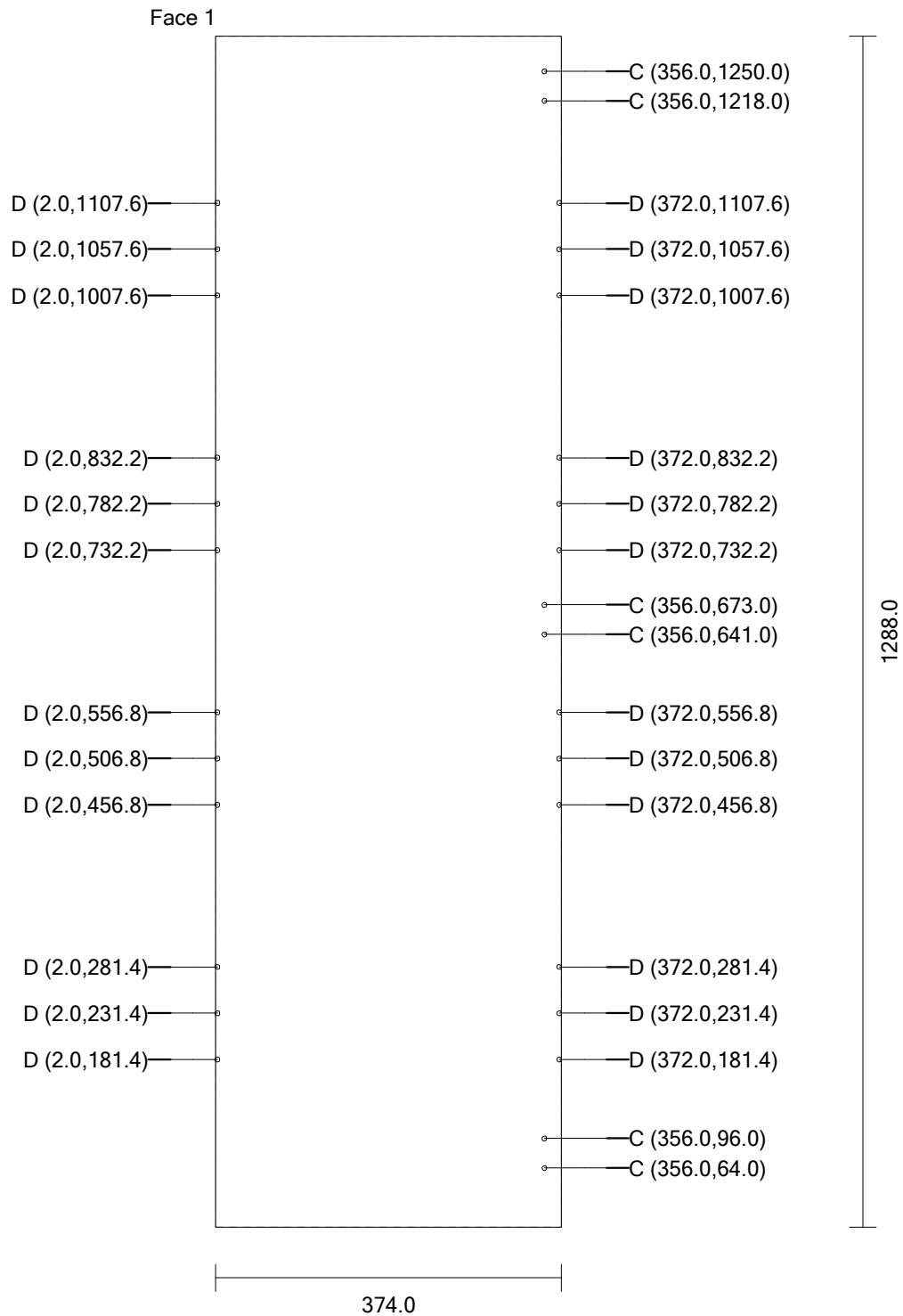

Back 08mm melon Height: 1358.0 Width: 2190.0 Thickness: 8.0 Quantity: 1

Face 1

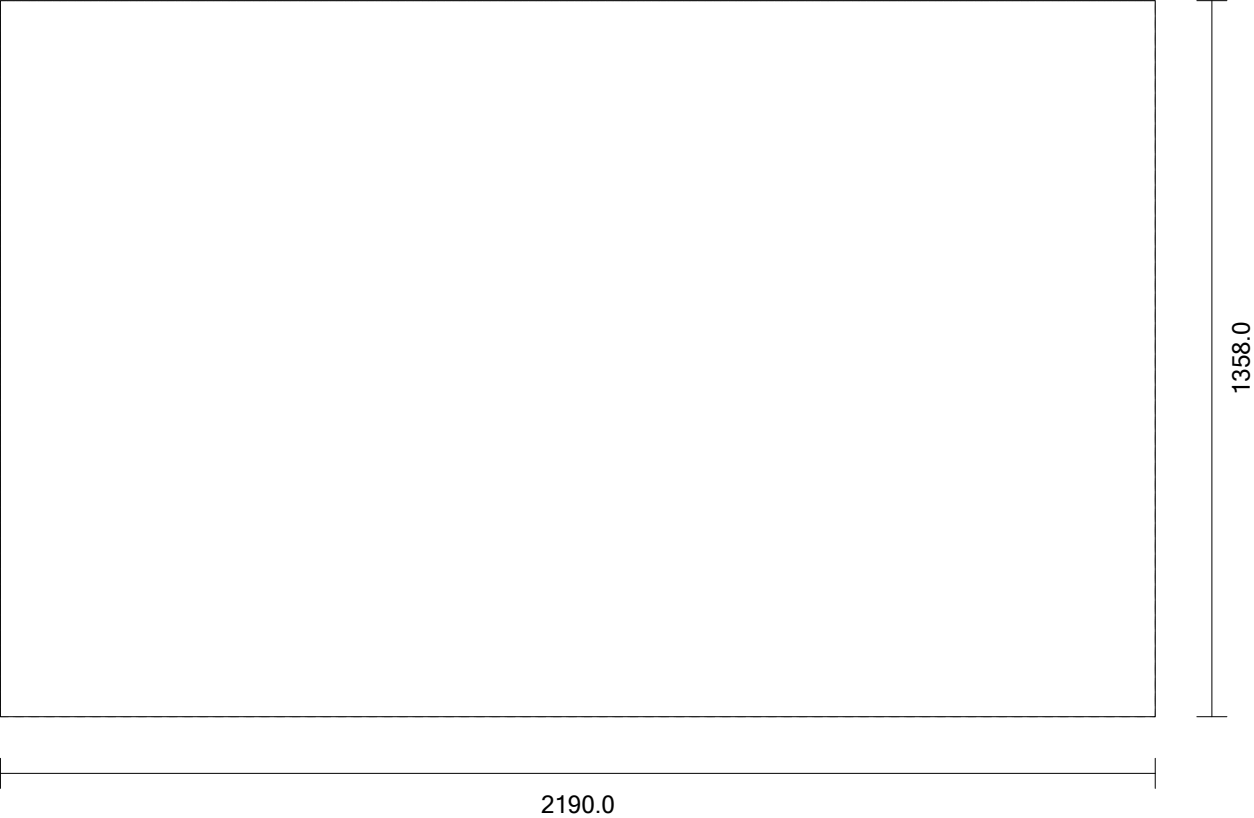

Mobile Shelve [1], Mobile ... 19mm Burnished Pine ven... Height: 528.8 Width: 433.0 Thickness: 19.0 Quantity: 16

Face 1

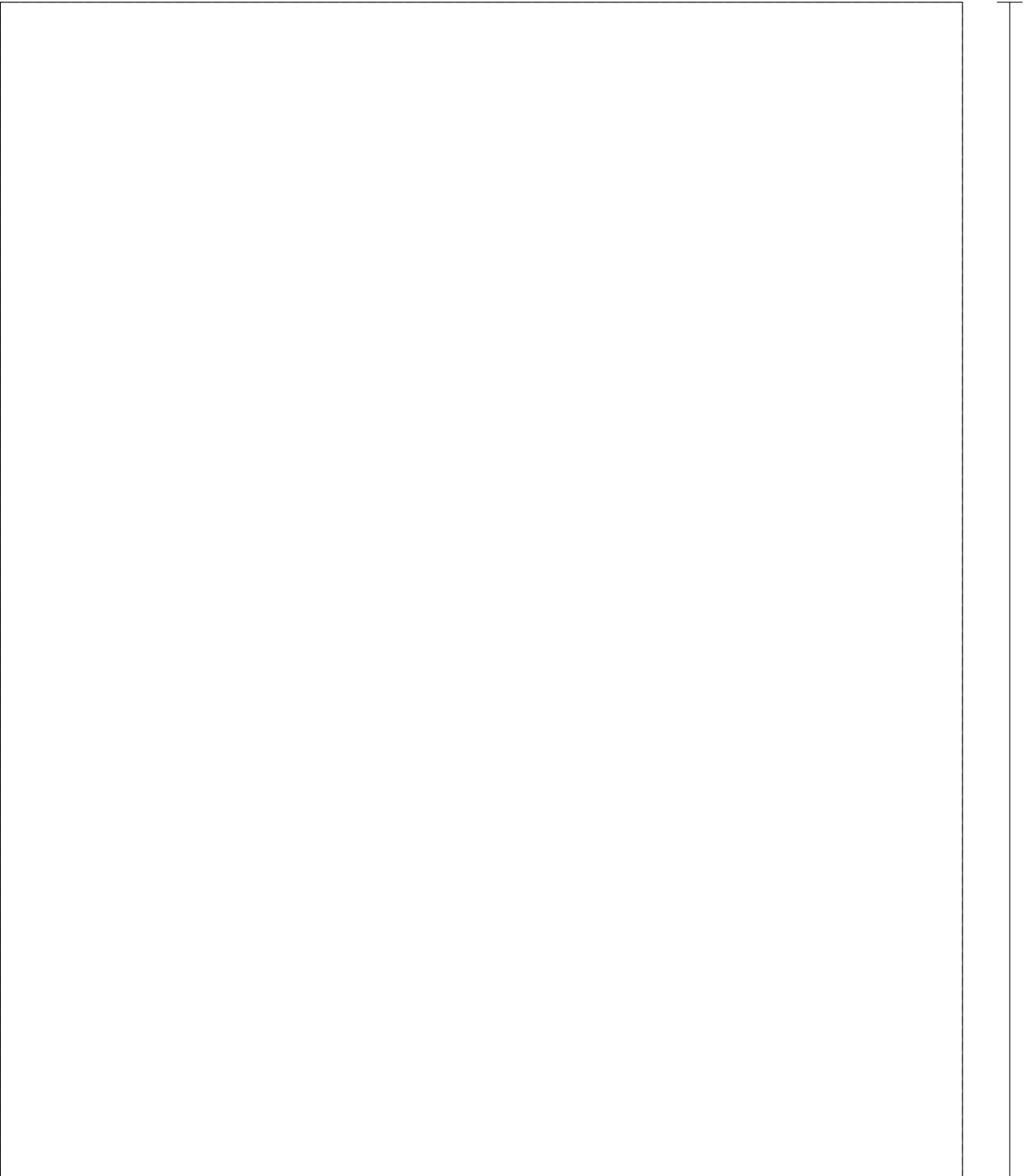

528.8

433.0

Vertical Division [1], Vertic... 19mm Burnished Pine ven... Height: 1358.0 Width: 366.0 Thickness: 19.0 Quantity: 2
00001179

Drilling B (4) Diameter: 8.0 Depth: 24.0
 E (48) Diameter: 5.0 Depth: 10.0

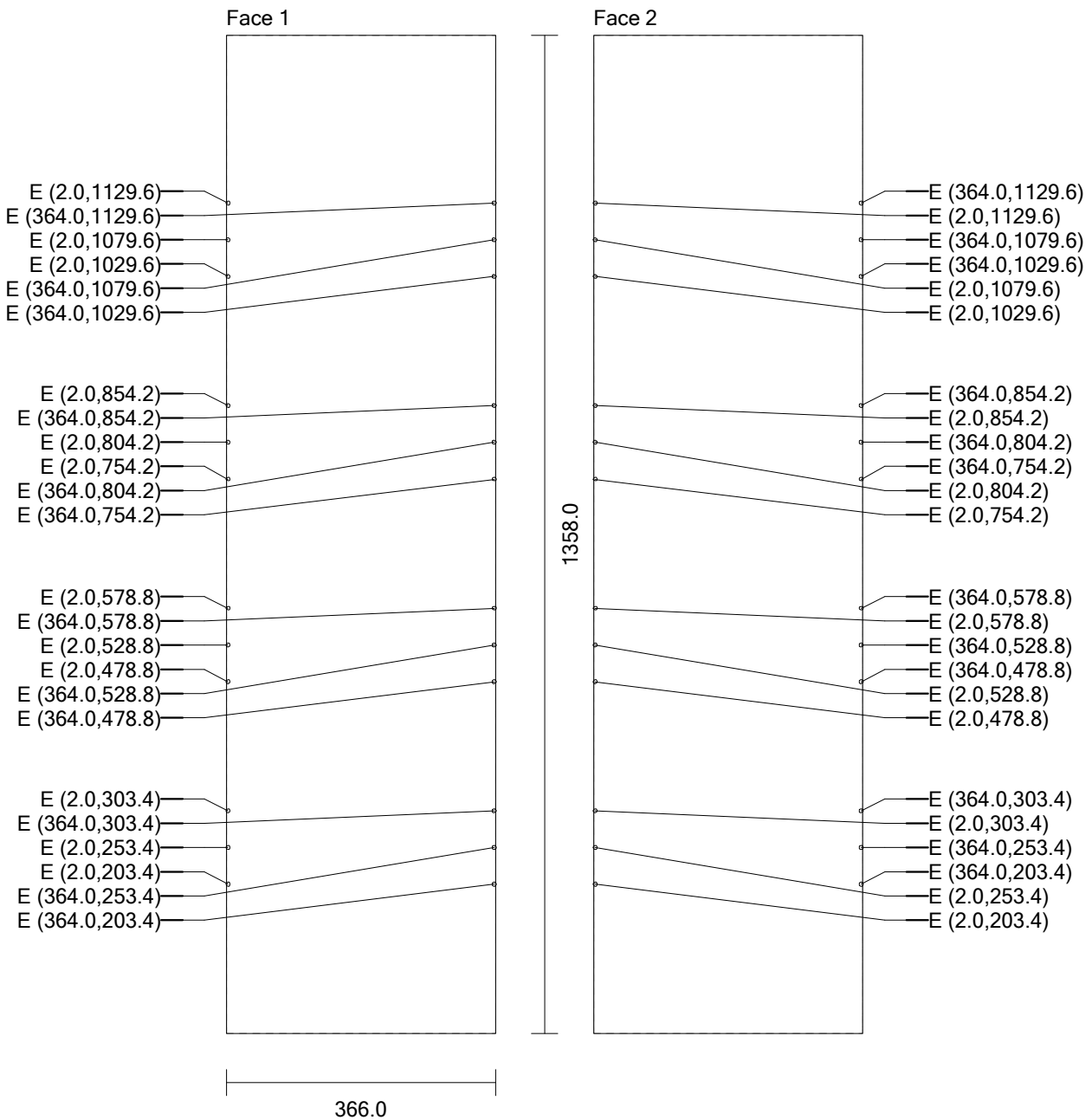

Vertical Division [2] 19mm Burnished Pine veneer Height: 1358.0 Width: 366.0 Thickness: 19.0 Quantity: 1
00001180

Drilling B (4) Diameter: 8.0 Depth: 24.0
E (48) Diameter: 5.0 Depth: 10.0
F (12) Diameter: 5.0 Depth: 9.0

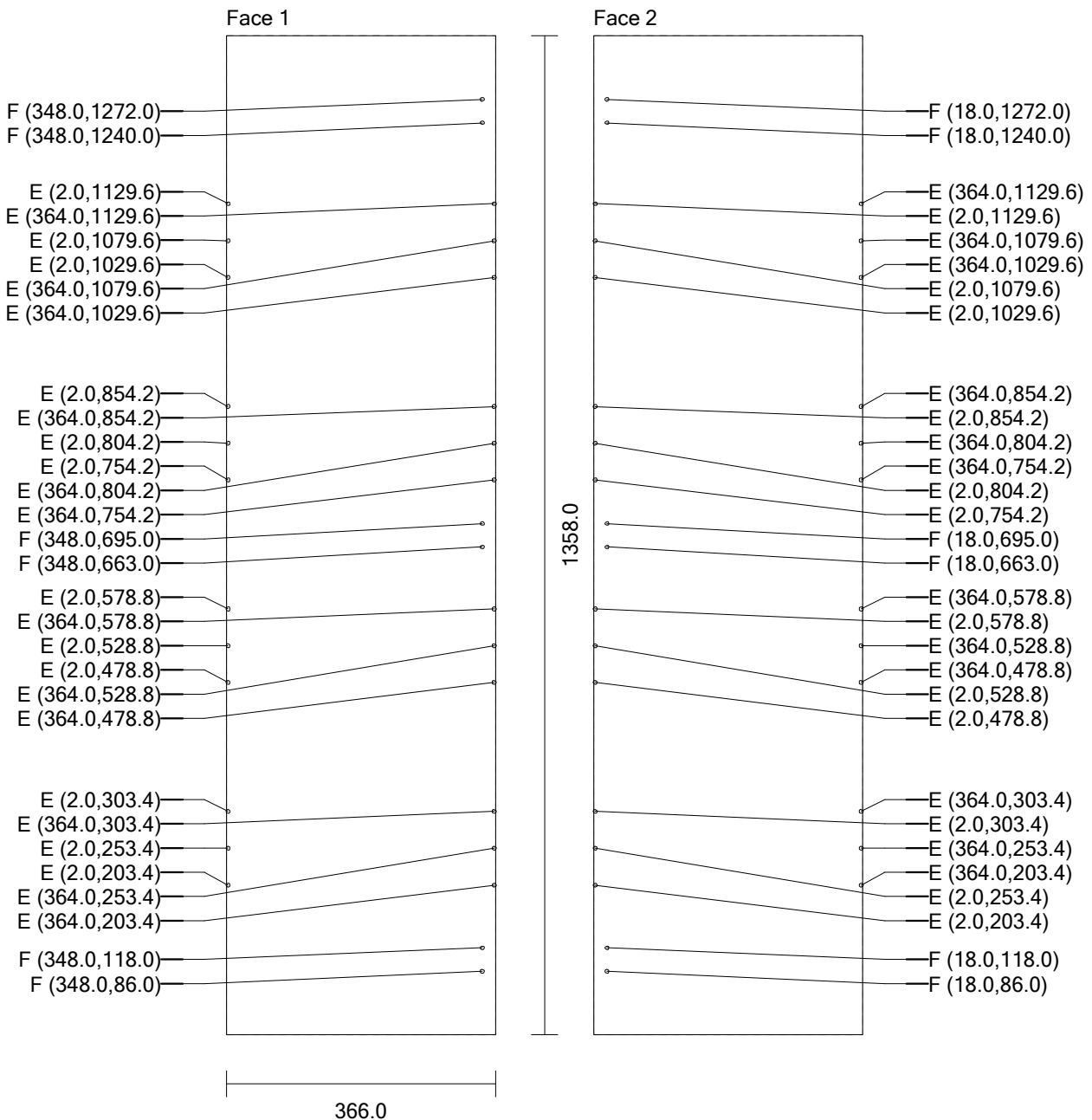

Simple Door [1], Simple Door [2], Simpl... 08mm Glass Height: 1258.0 Width: 428.8 Thickness: 8.0 Quantity: 4

